

GUIDE RAIL

When ordering, please check the size of guide rail and specification, because its dimensions decide all other parts, such as Safety device (safety gear), guide shoe, rail clip and other parts related to the Guide rail. For your quick reference, we'd like you to review the dimension of Guide rail as following.
(The product specifications are classified by naming as 5K, 8K, 13K, 18 K and 24 K, which K says kilogram in the weights of the part of 1 meter guide rail at 5 m total length.)

1. RAIL DIMENSION

Figure 1-1
Guide Rail feature

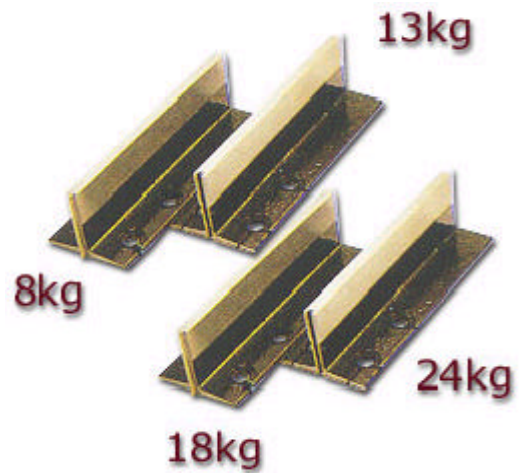
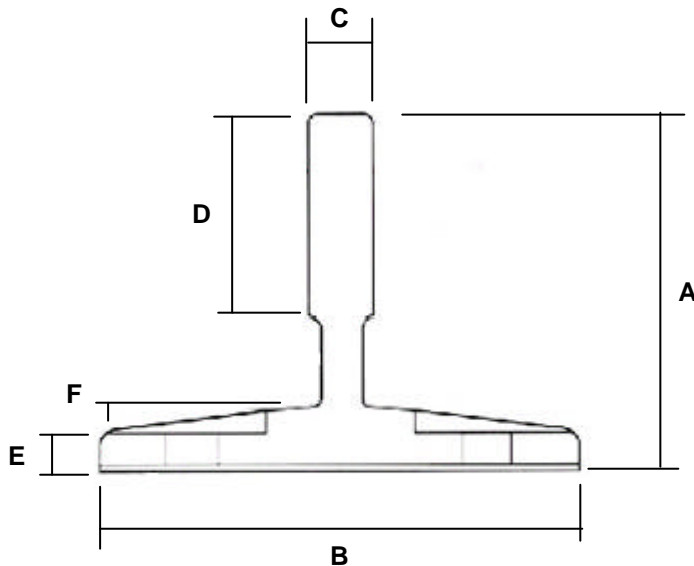
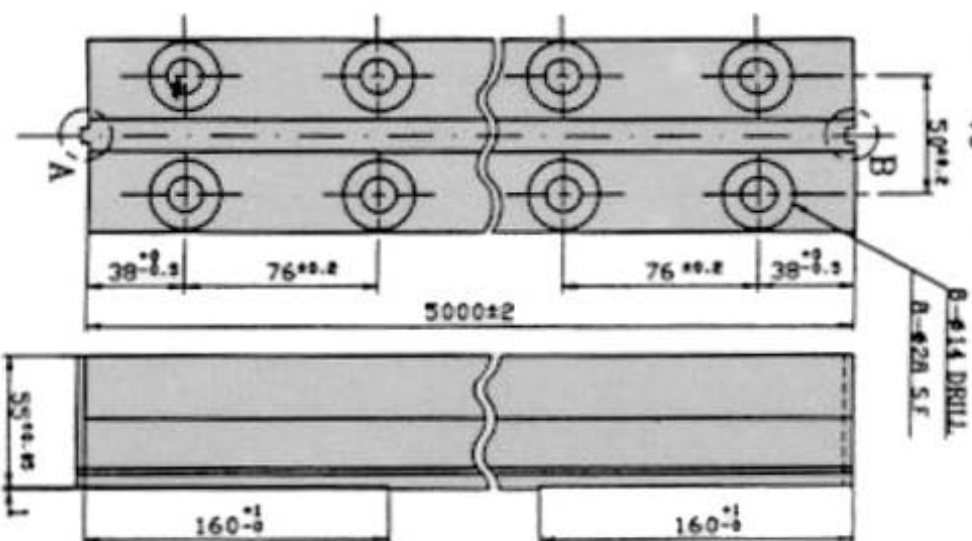
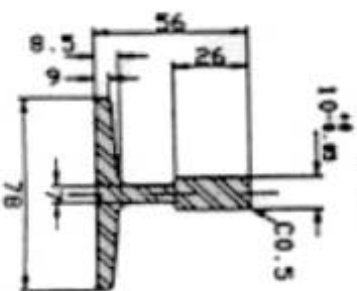

Table 1-1
Guide Rail Profile

GUIDE RAIL	RAIL DIMENSION (mm)					
	A	B	C	D	E	F
8K	55	78	10	26	6	8.5
13K(T89)	63	89	16	32	7.5	11.5
18K	88	114	16	38	8	11
24K(T127)	89	127	16	50	12.5	16

8K



CURVE	A	B	C
8K	3 - 4.0	3 - 5.1	3 ± 0.2

CURVE	D	E	F
8K	3 - 4.0	3 - 5.1	3 - 5.1

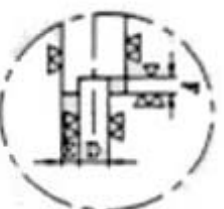
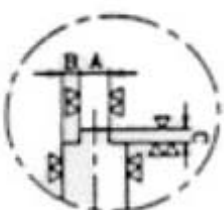

DETAIL A

DETAIL B

8K	P	3.0
	Q	3.0
	R	0.5

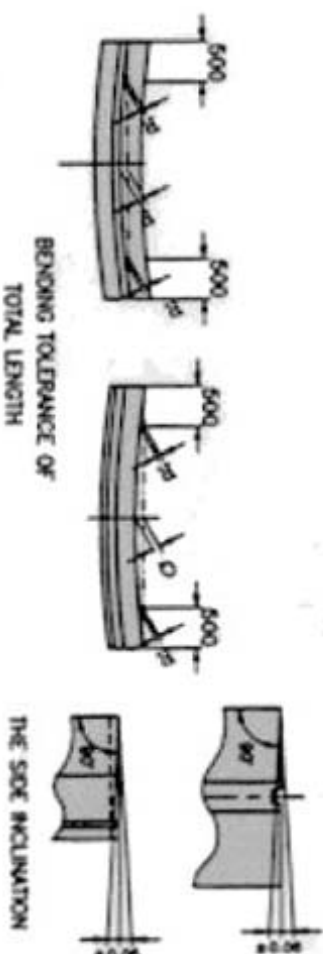

MEMO
 *PUT ON THE ANTI RUSTING OIL ON THE PROCESSING SURFACE.
 *TOLERANCE (AFTER ASSEMBLING) ± 0.02mm
 *TWISTING TOLERANCE OF TOTAL LENGTH ± 0.2mm

5					
4					
3					
2					
1	NO.	DESCRIPTION	MAT.	QUA.	REMARK
		SCALE N/S	DRW. NO.	DRWING	KS1701
		DATE 97.2.8	TITLE	8kg/m GUIDE RAIL	
	DRAWN	CHKD	INSP	APPR	

KEEP SANG CORP.

13K

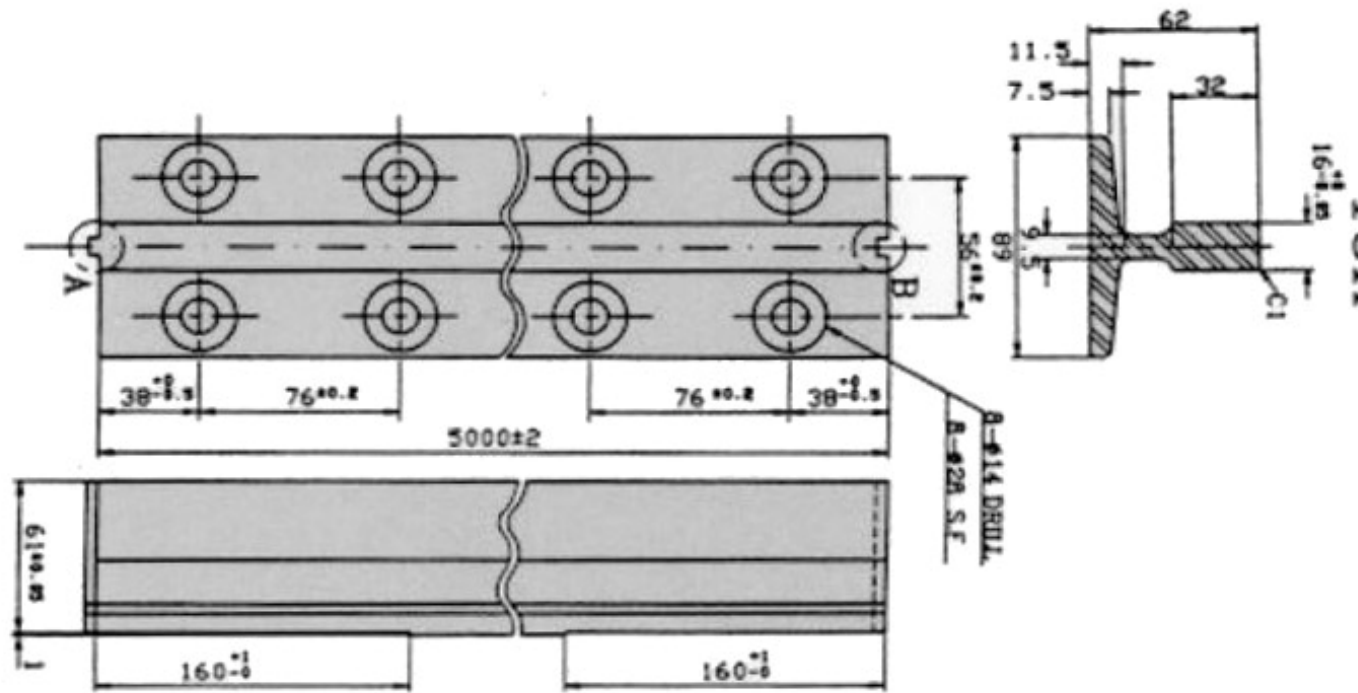

GUIDE	A	B	C
13K	4 ^{+0.02} _{-0.05}	6 ^{+0.02} _{-0.01}	4 ^{+0.2}

GUIDE	D	E	F
13K	4 ^{+0.02} _{-0.02}	6 ^{+0.01} _{-0.04}	4.5 ^{+0.2}

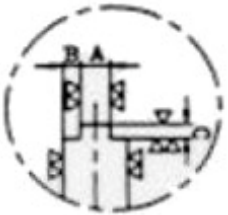

DETAIL A

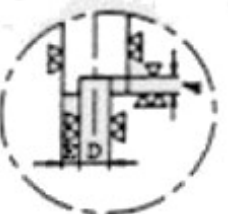

DETAIL B

	13K
P	2.0
Q	2.0
R	0.4

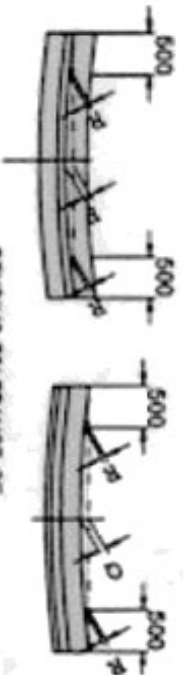

BENDING TOLERANCE OF TOTAL LENGTH

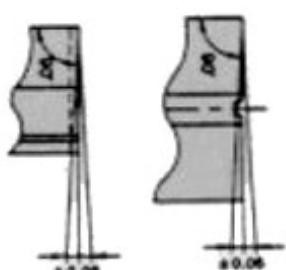

THE SIDE INCLINATION

MEMO
 *PUT ON THE ANTI RUSTING OIL ON THE PROCESSING SURFACE.
 *TOLERANCE (AFTER ASSEMBLING) ± 0.02mm
 *TWISTING TOLERANCE OF TOTAL LENGTH ± 0.2mm

NO	DESCRIPTION	MAT	QUA	REMARK
1	SCALE N/S	DRWING	KS1702	
2	DATE 97.2.8			
3				
4				
5				

13kg/m GUIDE RAIL

KEEP SANG CORP.

Formed Guide Rail Specification

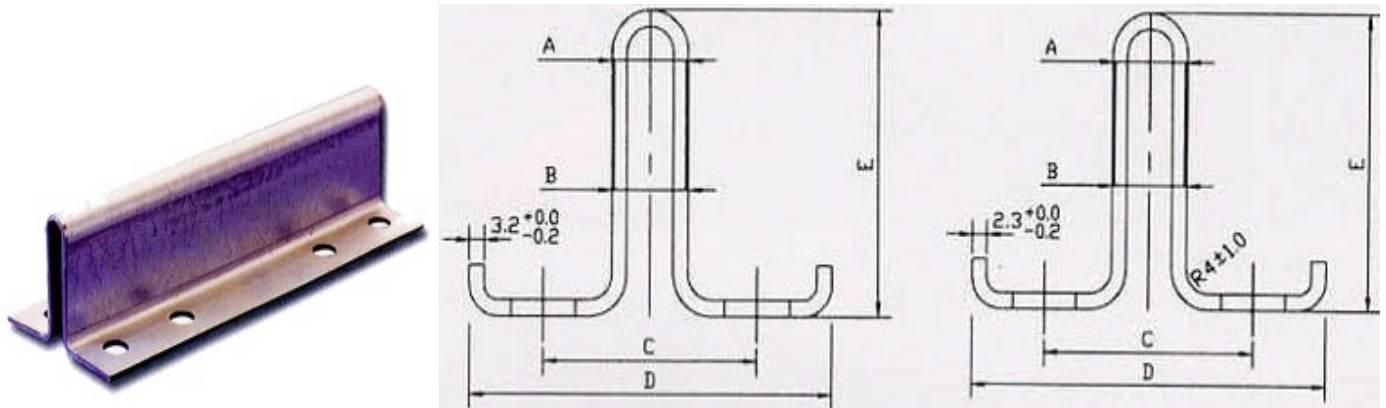

You can refer to following dimension for the drawing above for details on rails.

ITEM	A	B	C	D	E	LENGTH	THICKNESS	MATERIAL
3K	16.4 ± 0.5	16.4 ± 0.5	44 ± 0.5	78 ± 1.0	60 ± 1.0	5000 ± 3	2.3t	SGH41
5K	16.4 ± 0.5	16.4 ± 0.5	44 ± 0.5	78 ± 1.0	60 ± 1.0	5000 ± 3	3.2t	SGH41
7K	19 ± 0.5/td>	19 ± 0.5	54 ± 0.6	96 ± 1.0	88 ± 1.0 - 0.5	5000 ± 3	3.2t	SGH41