

8K

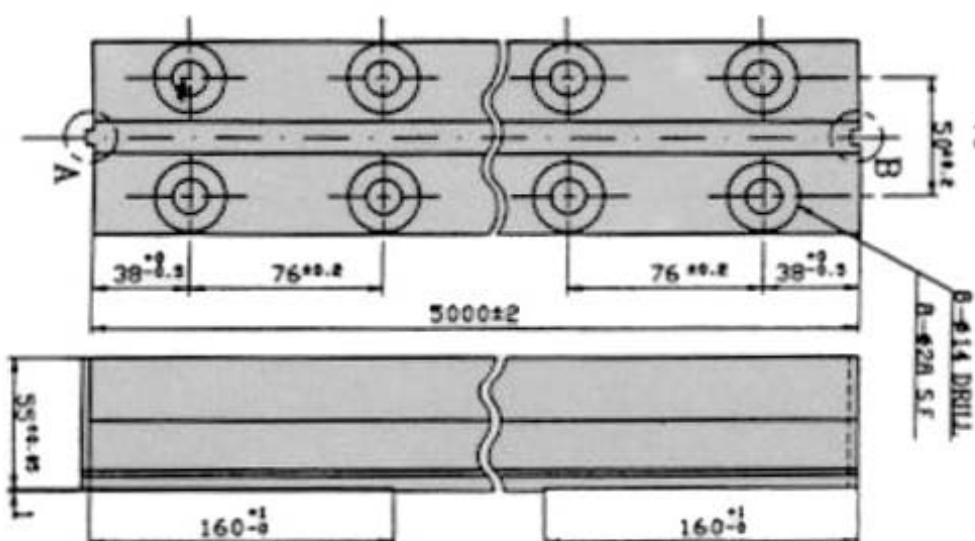

GUIDE	A	B	C
OKG	-0.02 -0.05	3.5 4.0	3 4

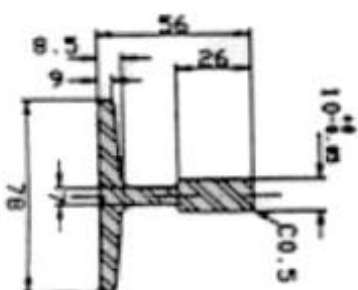
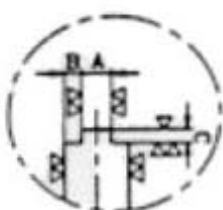

### DETAIL A

GUIDE	D	E	F
8XG	3 1.5 3 0.5	3 5.0 3 0.4	3 5.0 3 0.2

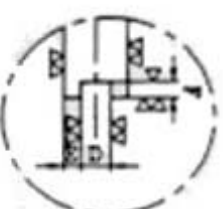

### DETAIL, B

	OK
P	3.0
Q	3.0
R	0.5

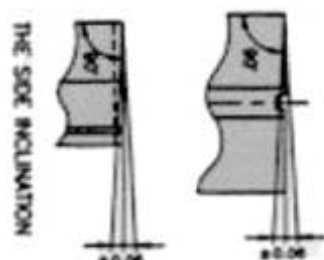
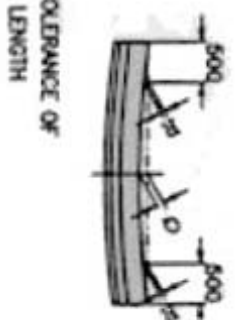
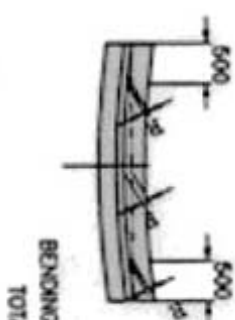

MEMO

- \*PUT ON THE ANTI RUSTING OIL ON THE PROCESSING SURFACE
- \*TOLERANCE (AFTER ASSEMBLING)  $\pm 0.02\text{mm}$
- \*TWISTING TOLERANCE OF TOTAL LENGTH  $\pm 0.2\text{mm}$

[illegible]

## 164

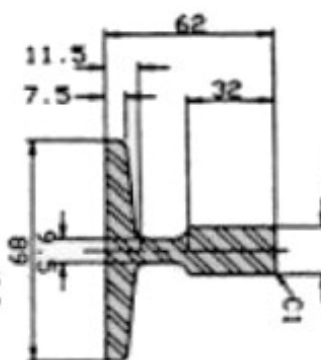

A-014 DRILL.  
A-028 S.F.

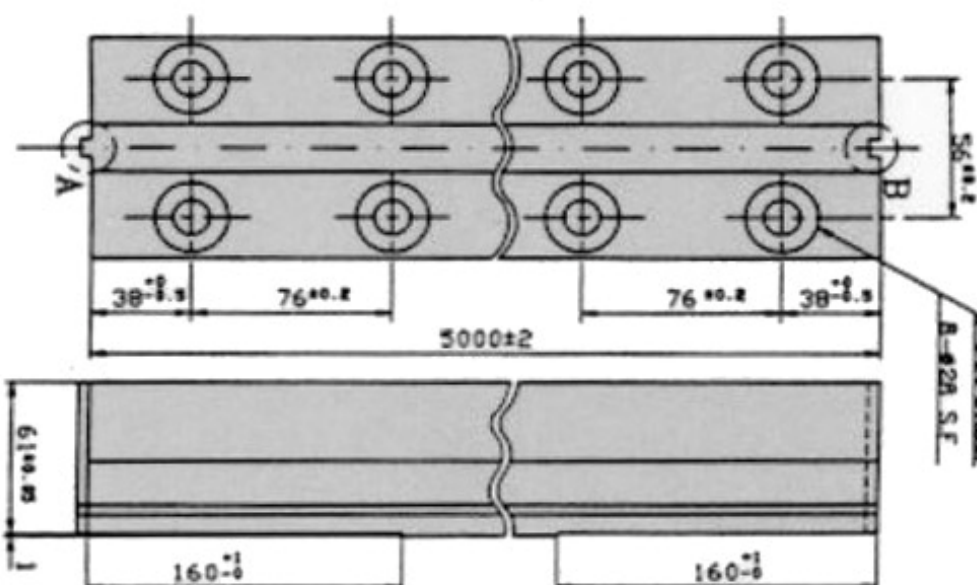

GUIDE	A	B	C
13KG	-3.92 -0.05	+3.92 -0.01	4 00.2

curde	D	E	F
13KG	4 +0.02	6 -0.04	4 +0.02

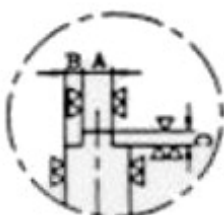

### DETAIL A

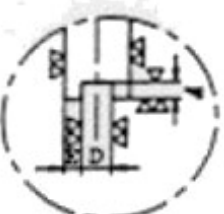

### DETAIL, B

	13K
P	2.0
Q	2.0
R	0.4

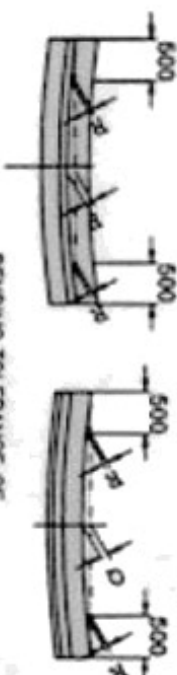
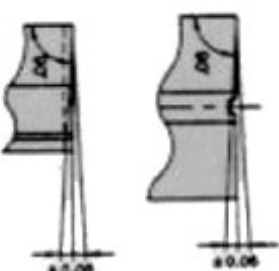
BENDING TOLERANCE ON  
TOTAL LENGTH

### THE SOE INCLINATION

—MEMO—

- PUT ON THE ANTI RUSTING OIL ON THE PROCESSING SURFACE.
- TOLERANCE (AFTER ASSEMBLING)  $\leq 0.02\text{mm}$
- FINISHING TOLERANCE OF TOTAL LENGTH  $\leq 0.2\text{mm}$

5						
4						
3						
2						
1						
NO	DESCRIPTION	MAT	QTY	REMARK		
	SCALE	OFF NO	DRAWING	KS1702		
	N/S					
	DATE	TITLE				
	87.2.8	1 3kg/m GUIDE RAIL				
DRAWN	CHKD	INSP	APPR			

KEE SANG CORP.

KEE SANG CORP.

## Formed Guide Rail Specification

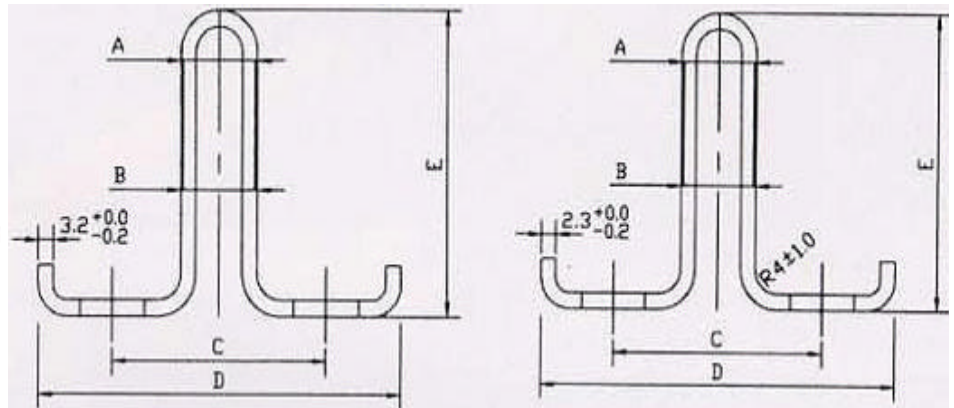
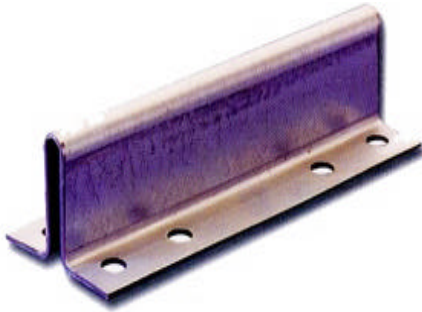

You can refer to following dimension for the drawing above for details on rails.

ITEM	A	B	C	D	E	LENGTH	THICKNESS	MATERIAL
3K	$16.4 \pm 0.5$	$16.4 \pm 0.5$	$44 \pm 0.5$	$78 \pm 1.0$	$60 \pm 1.0$	$5000 \pm 3$	2.3t	SGH41
<b>5K</b>	<b><math>16.4 \pm 0.5</math></b>	<b><math>16.4 \pm 0.5</math></b>	<b><math>44 \pm 0.5</math></b>	<b><math>78 \pm 1.0</math></b>	<b><math>60 \pm 1.0</math></b>	<b><math>5000 \pm 3</math></b>	<b>3.2t</b>	<b>SGH41</b>
7K	$19 \pm 0.5$ /td>	$19 \pm 0.5$	$54 \pm 0.6$	$96 \pm 1.0$	$88 \pm 1.0 - 0.5$	$5000 \pm 3$	3.2t	SGH41